

Advin COVID-19 Antigen Test @Home

Quick Reference Guide

For use under Emergency Use Authorization only
For in vitro diagnostic use

KIT CONTENTS



Test Cassette



Disposal Bag



Bring test kit to room temperature (59-86 °F / 15-30 °C). Read the instructions before starting the test procedure. Check expiration date printed on test. For information about current expiration dates for at-home OTC COVID-19 diagnostic tests, visit At-Home OTC COVID-19 Diagnostic Tests: <https://www.fda.gov/medical-devices/coronavirus-covid-19-and-medical-devices/home-otc-covid-19-diagnostic-tests>

SPECIMEN COLLECTION

Self-collected the nasal swab samples by individuals aged 14 years or older. Or adult collect nasal swab samples from individuals aged 2 years or older. Children aged 13 years old and younger should be tested by a parent or legal guardian.

TEST PROCEDURE

1

Wash or sanitize your hands and keep them dry before testing.



2

Peel off the aluminum foil on the extraction buffer tube.

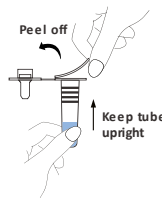

3

Place the extraction buffer tube in the tube holder on the kit box.

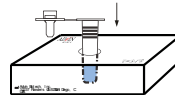

4

Remove nasal swab from its packaging. **DO NOT** touch the swab tip.

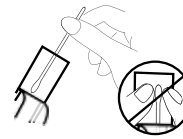

5

Prepare to collect sample. If collecting from a child, you may need another adult's head while swabbing.



6

Gently insert swab 1/2 - 3/4 inch into **first** nostril, or until you feel resistance.

Slowly make at least **5 rotations** with the swab firmly against the walls of the nostril for approximately 15 seconds.

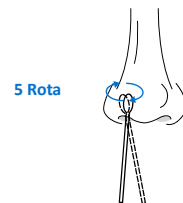

7

Repeat step #6 in your **second** nostril using the same swab.



⚠️ **Swab both nostrils**
DO NOT insert the swab any deeper if you feel resistance or pain.
Inaccurate test result may occur if the nasal swab specimen is not properly collected.
Collect specimen and immediately perform the test according to the instructions.

8

Take the tube out of the tube holder. Place the swab into the tube, ensure the swab tip is **in the liquid inside the tube.**

Stir the swab tip against the bottom and side of the tube for at least **15 times.**

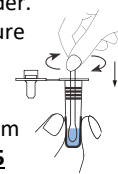

9

Squeeze the swab tip at least **5 times** from outside of the tube while the swab tip remains in the liquid.

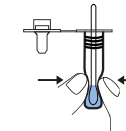

10

While **squeezing** the sides of the vial firmly, **pull** the swab out to remove excess liquid.

Dispose of the swab in provided disposal bag.

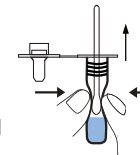

11

Firmly press the dropper tip on the extraction buffer tube.

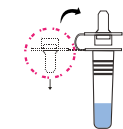

12

Remove the cassette from its packaging and place it on a clean flat surface. Find the Result Window and Specimen Well on the cassette.

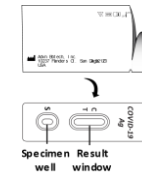

13

Add 3 drops of solution into the circular sample well, labeled as "S" on the test cassette.

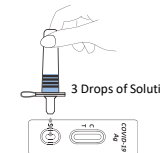

⚠️ **Do not add test sample to the rectangular results window. Do not touch the sample well with dropper tip. Do not hold the dropper tube more than 1/4" above sample well. Adding other than the recommended number of drops may result in inaccurate results.**

14

Set timer for 10 minutes. Do not move or lift the test cassette. Read the test result at 10 minutes.

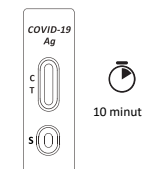

⚠️ **Do not read test results before 10 minutes or after 30 minutes**

15

Dispose of all used test kit components in the Disposal Bag provided. Dispose the bag in household trash. Wash your hands or use hand sanitizer after completing all steps.



RESULT INTERPRETATION

Repeat testing is needed to improve test accuracy. Please follow the table below when interpreting test results for COVID-19.

Status on First Day of Testing	First Result Day 1	Second Result Day 3	Third Result Day 5	Interpretation
With Symptoms	Positive	N/A	N/A	Positive for COVID-19
	Negative	Positive	N/A	Positive for COVID-19
	Negative	Negative	N/A	Negative for COVID-19
Without Symptoms	Positive	N/A	N/A	Positive for COVID-19
	Negative	Positive	N/A	Positive for COVID-19
	Negative	Negative	Positive	Positive for COVID-19
	Negative	Negative	Negative	Negative for COVID-19

Results should be considered in the context of an individual's recent exposures, history, and the presence of clinical signs and symptoms consistent with COVID-19.

COVID-19 Positive (+)

If the Control (C) line and the Test (T) line are visible, the test is positive. Any faint visible red/purple test (T) line with the control line (C) should be read as positive.

You do not need to perform repeat testing if you have a positive result at any time. A positive test result means that the virus that causes COVID-19 was detected in your sample and it is very likely you have COVID-19 and are contagious. Please contact your doctor/primary care physician or your local health authority immediately and adhere to the local guidelines regarding self-isolation. There is a very small chance that this test can give a positive result that is incorrect (a false positive). Individuals who test positive with the Advin COVID-19 Antigen Test @Home should self-isolate and seek follow up care with their physician or healthcare provider.

COVID-19 Negative (-)

If the Control (C) line is visible, but the Test (T) line is not visible, the test is negative.

To increase the chance that the negative result for COVID-19 is accurate, you should:

- Test again in 48 hours if you have symptoms on the first day of testing.
- Test 2 more times at least 48 hours apart if you do not have symptoms on the first day of testing.

A negative test result indicates that the virus that causes COVID-19 was not detected in your sample. A negative result is presumptive, meaning it is not certain that you do not have COVID-19. You may still have COVID-19 and you may still be contagious. There is a higher chance of false negative results with antigen tests compared to laboratory-based tests such as PCR. If you test negative and continue to experience COVID-19-like symptoms, (e.g., fever, cough, and/or shortness of breath) you should seek follow up care with your health care provider.

All negative results should be treated as presumptive and confirmation with a molecular assay may be necessary if there is a high likelihood of SARS-CoV-2 infection, such as in an individual with a close contact with COVID-19 or with suspected exposure to COVID-19 or in communities with high prevalence of infection. Negative results do not rule out SARS-CoV-2 infection and should not be used as the sole basis for treatment or patient management decisions, including infection control decisions.

Invalid

If the control (C) line is not visible, the test is invalid. Re-test with a new swab and new test device. Insufficient specimen volume or incorrect procedural techniques are the most likely reasons for control line failure. Review the procedure and repeat the test with a new test. If the problem persists, discontinue using the test kit immediately and contact your local distributor or manufacturer for technical support.

Report your test result(s) at **HYPERLINK:**

https://makemytestcount.org/?utm_source=substack&utm_medium=email
MakeMyTestCount.Org – this voluntary and anonymous reporting helps public health teams understand COVID-19 spread in your area and across the country and informs public health decisions.

